

# GR333N

East Fulton Market Opportunity





# 333 N Green

GR333  
GR333

## Overview

553,442 SF, 19-story office tower in  
Fulton Market

## Top Tier Amenities

---

Outdoor terrace overlooking the city and Fulton Market

---

Tenant lounge with grab-and-go food service

---

Bar and coffee servery

---

Gaming area

---

Full service fitness center and yoga room

---

On-site parking for over 300 cars

---

Secure bike room

---

Conference center with pre-function accommodations  
from four to 100 people

---

Shuttle service to and from Ogilvie and Union train stations

---

Studio Three, Sunda, and SunLife Organics located onsite

---

Hidden library

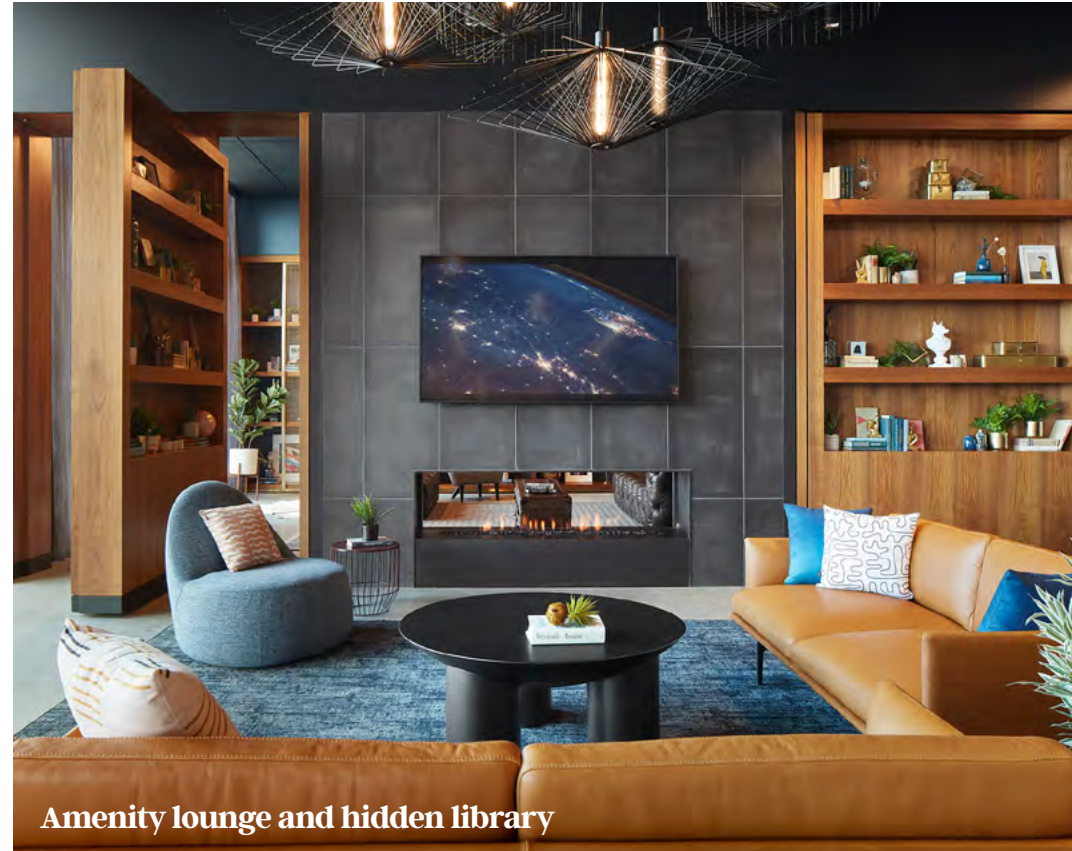

Amenity lounge and hidden library



Studio Three bike room



Indoor/outdoor workspace and terrace



Amenity lounge and cafe



# The Opportunity

GR333  
GR333

## Overview

96,715 SF of high-end built space

## Details

6th floor premises is directly adjacent to 333 building amenities

Access to 20 dedicated on-site parking spaces with additional public garage spaces available

Interconnecting staircase between 6th & 7th floors

18' ceilings on 6th floor,  
14' on 7th & 8th floors

Large catering kitchen with black iron

Private outdoor space available

Future expansion opportunities throughout building

Exterior signage opportunity

Access to FF&E, AV/IT

Floor	RSF
6	15,250
7	40,733
8	40,732
<b>Total</b>	<b>96,715</b>

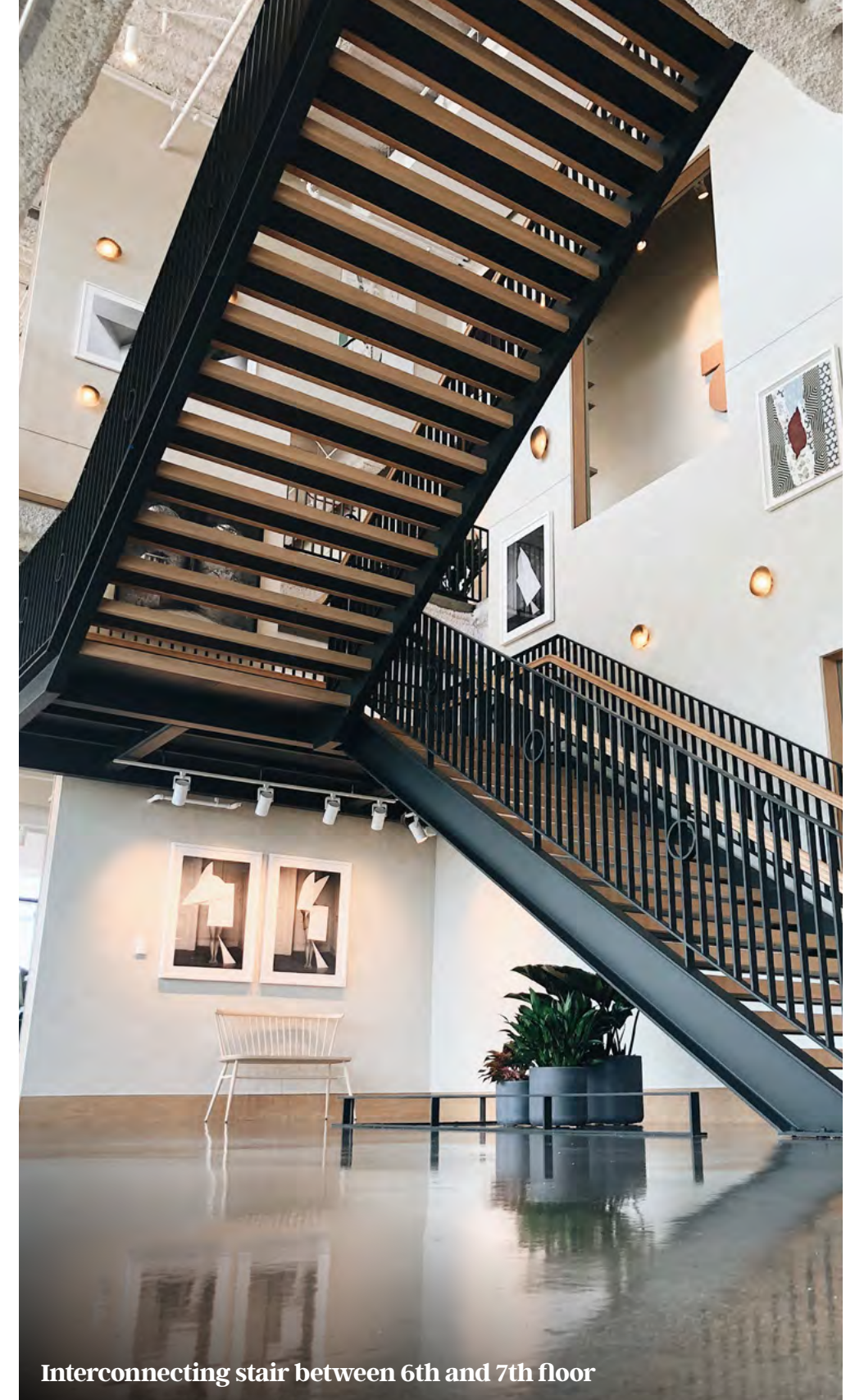



# Signage Opportunity

GR333  
GR333



## Highly visible Halsted Street tenant branding

Exterior signage (North facing on NE corner of building)

6' x 35' measurement

Visible to more than 24,000 vehicles per day

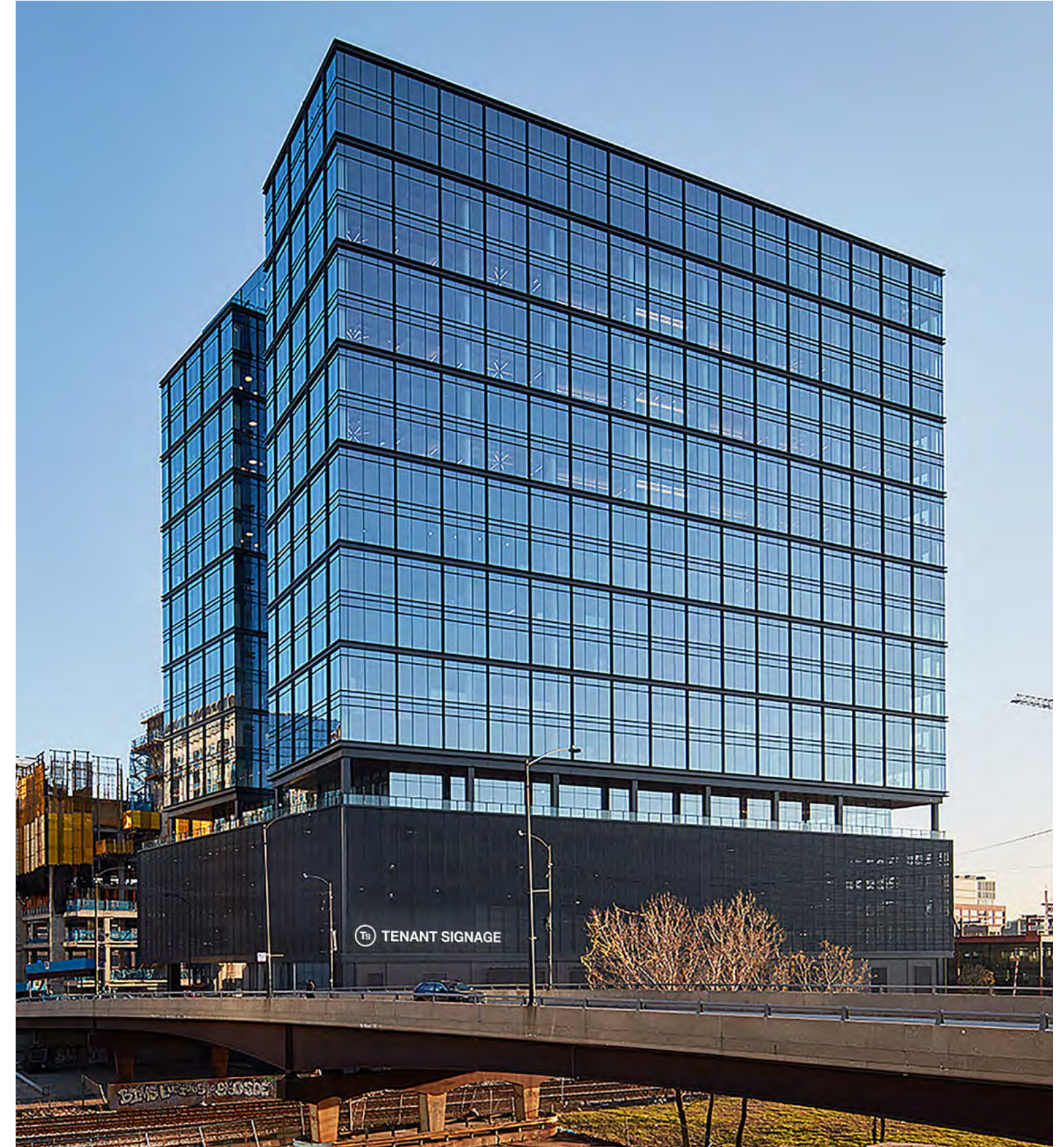



# Floorplans

6th floor | 15,250 RSF

**LEGEND**

BATHROOMS     COAT CLOSET  
 ELEVATOR     ENTRANCE

**GENERAL ACCESS**

BATHROOMS

**MEETING & EVENT ACCESS**

GALLERY SPACE  
 370 PERSON CAPACITY  
 NOURISH

Floor	RSF
6	15,250
7	40,733
8	40,732
<b>Total</b>	<b>96,715</b>

MEETING ROOMS	CAPACITY	QUANTITY
Huddles	2-4	7
Conference Rooms	8-14	4
Phone Rooms	1	10
COMMON SPACE		SEATS
Commons	12,000	85

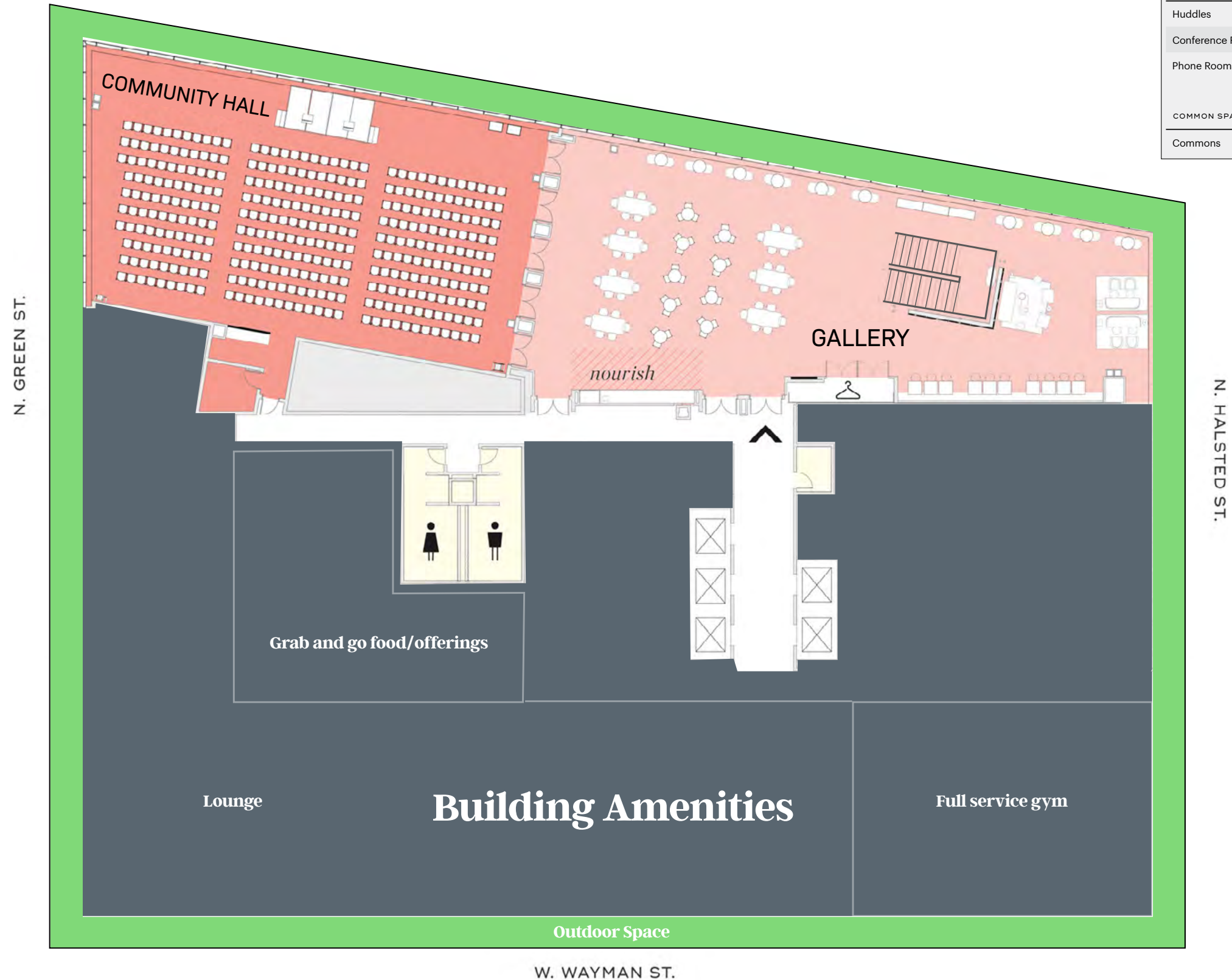

W. WAYMAN ST.

# Floorplans

7th floor | 40,733 RSF

Office electrical coring complete with an abundance of power sources

**LEGEND**

BATHROOMS	COAT CLOSET
RESPITE ROOM	ENTRANCE
ELEVATOR	

**GENERAL ACCESS**

- BATHROOMS & RESPITES

**MEETING & EVENT ACCESS**

- GALLERY SPACE
- MEETING ROOMS
- NOURISH & WELCOME

Floor	RSF
6	15,250
7	40,733
8	40,732
<b>Total</b>	<b>96,715</b>

MEETING ROOMS	CAPACITY	QUANTITY
Huddles	2-4	7
Conference Rooms	8-14	4
Phone Rooms	1	10

COMMON SPACE	SQ FT	SEATS
Commons	12,000	85



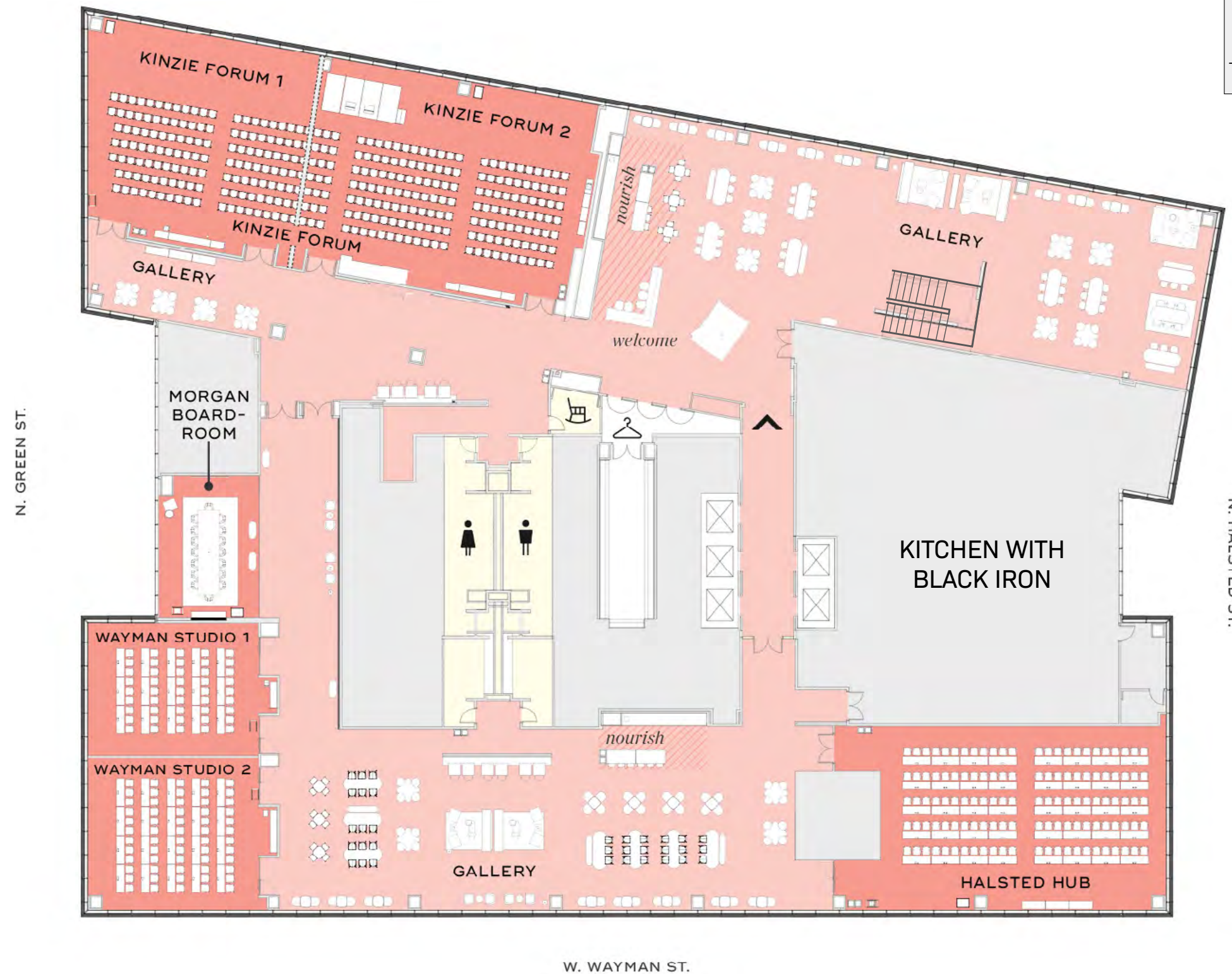

# Floorplans

8th floor | 40,732 RSF

**LEGEND**

BATHROOMS	PANTRY
PHONE ROOM	PRINTER ROOM
RESPITE ROOM	ENTRANCE
ELEVATOR	

**GENERAL ACCESS**

- BATHROOMS & RESPITES

**WORKPLACE ACCESS**

- WORKSUITES
- INTERNAL SUITE
- NOURISH
- COMMON SPACE
- MEETING ROOMS

Floor	RSF
6	15,250
7	40,733
8	40,732
<b>Total</b>	<b>96,715</b>



MEETING ROOMS	CAPACITY	QUANTITY
Huddles	2-4	7
Conference Rooms	8-14	4
Phone Rooms	1	10

COMMON SPACE	SQ FT	SEATS
Commons	12,000	85

W. WAYMAN ST.



# Location

GR3333  
GR3333  
GR3333

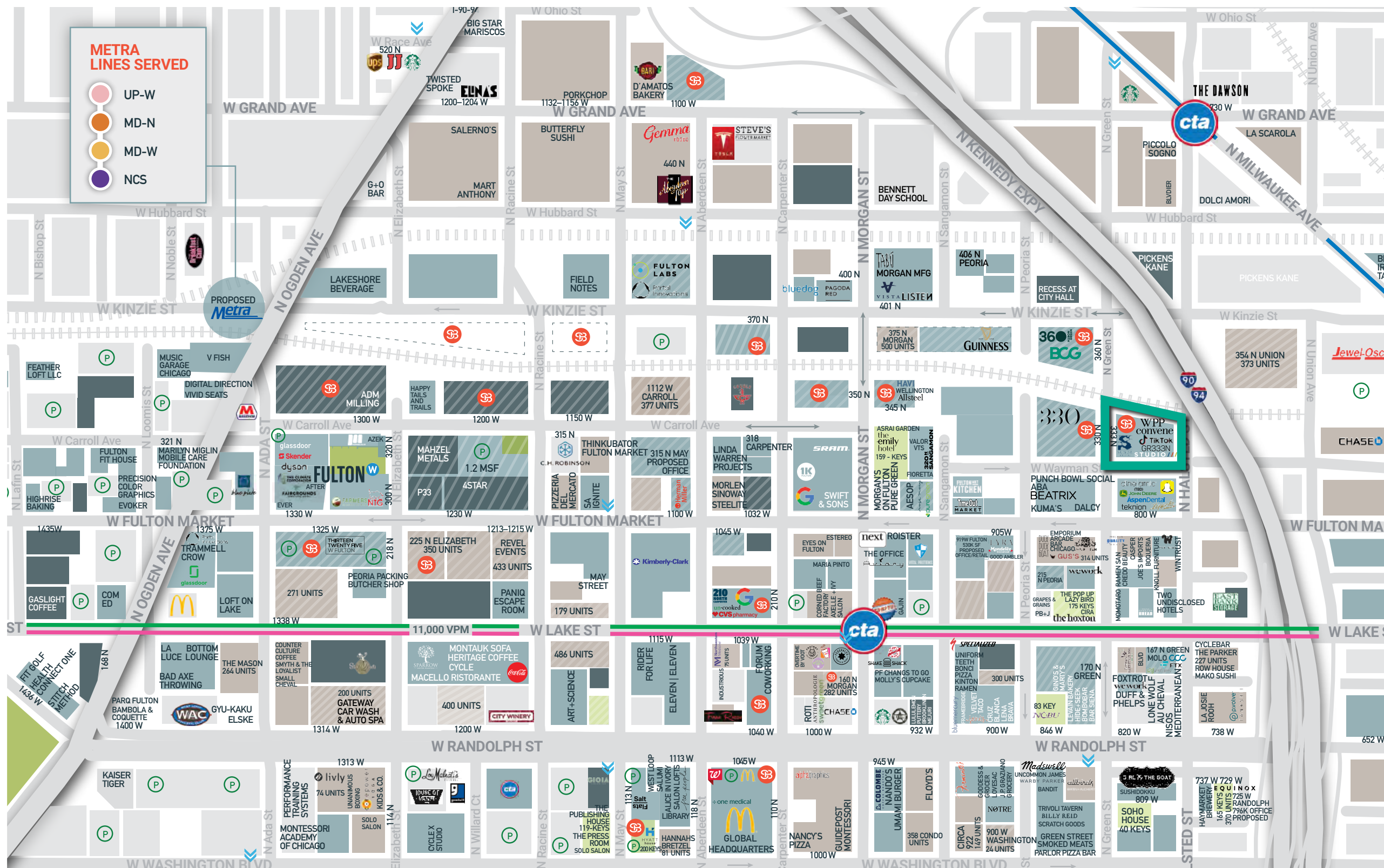

**METRA LINES SERVED**

- UP-W
- MD-N
- MD-W
- NCS

**FULTON MARKET MAP LEGEND**

- Commercial / Office
- Industrial
- Residential
- Hotels
- Parks
- Planned
- CTA 'L' Station
- Divvy Station
- Parking





**FOR LEASING INFORMATION, CONTACT**

**DANIELLA HEMSLEY**

[dhemsley@sterlingbay.com](mailto:dhemsley@sterlingbay.com)  
847.849.9578

**DAVE GLOOR**

[dgloor@sterlingbay.com](mailto:dgloor@sterlingbay.com)  
708.224.8362

**AUSTIN LUSSON**

[alusson@sterlingbay.com](mailto:alusson@sterlingbay.com)  
708.744.5386

**JESSICA BROWN**

[jbrown@sterlingbay.com](mailto:jbrown@sterlingbay.com)  
847.420.0044

**RUSSELL CORA**

[rcora@sterlingbay.com](mailto:rcora@sterlingbay.com)  
312.952.0279

**OFFICE@STERLINGBAY.COM**